

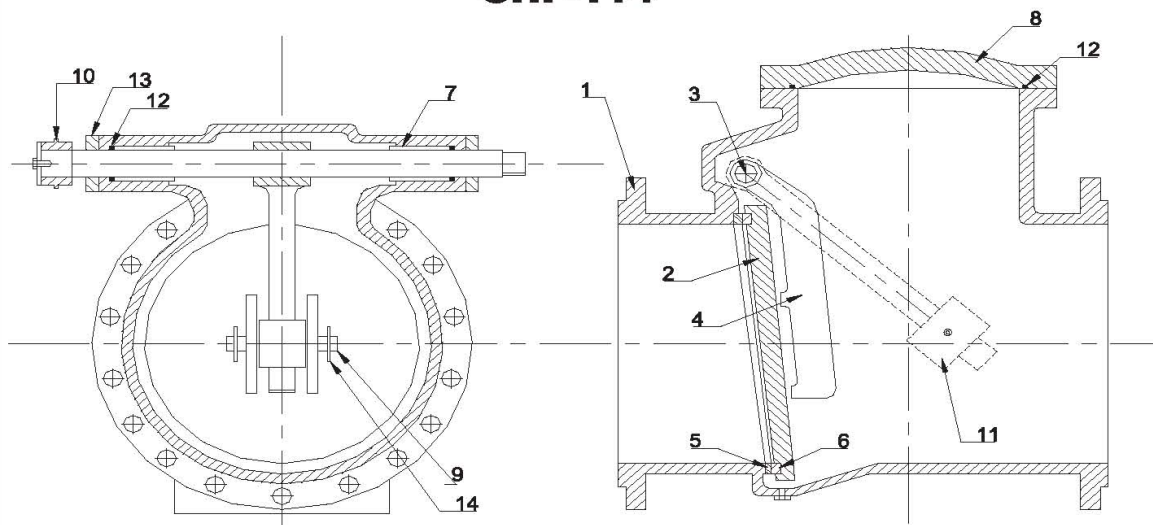

SAUDI PIPE SYSTEMS CO.

SWING CHECK VALVE CHF-114



MATERIAL LIST

| Part | Description | Material |
|------|-------------|-------------------------|
| 1 | Body | Ductile Iron GGG 50 |
| 2 | Disc | Ductile Iron GGG 50 |
| 3 | Shaft | X20Cr13 St. St. / SS304 |
| 4 | Rocker Arm | Ductile Iron GGG 50 |
| 5 | Body Seat | SS304 / Rg5 Bronze |
| 6 | Disc Seat | SS304 / Rg5 Bronze |
| 7 | Bearing | Rg5 Bronze |
| 8 | Cover | Ductile Iron GGG 50 |
| 9 | Hinge Pin | X20Cr13 St. St. / SS304 |
| 10 | Lever | St-37 Steel |
| 11 | Weight | Ductile Iron GGG 50 |
| 12 | O-Ring | EPDM Rubber |
| 13 | Shaft Cover | Ductile Iron GGG 50 |
| 14 | Split Pins | SS304 |

Working Pressure : 16 Bar .
 Drilling : DIN 2501 , ISO 2531.
 Ductile Iron : DIN EN 1563
 Face To Face : BS 5153
 Coating : Epoxy 200-300 Mic.
 Ductile Iron : DIN EN 1563 / ASTM 536A.
 SS 304 : ASTM 582A.
 Hydrotesting : DIN 3230
 Feature : anti slam valve with counter weight.

Design Mechanical Data, Dimension , Materials and weight are subject to change without notice



SAUDI PIPE SYSTEMS CO.

SWING CHECK VALVE CHF-114

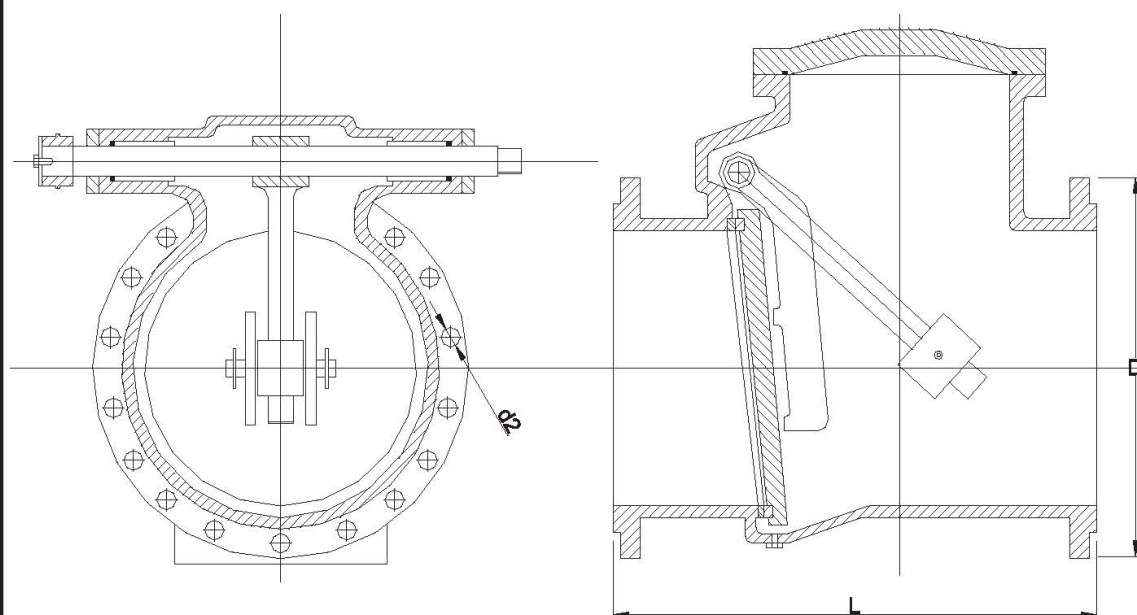

| Srtandard | DN | 100 | 150 | 200 | 250 | 300 | 350 | 400 | 450 | 500 | 600 | 700 | 900 |
|-----------|----|-----|-----|-----|-----|-----|-----|-----|-----|-----|-----|------|------|
| BS5153 | L | 292 | 330 | 356 | 495 | 622 | 698 | 787 | 914 | 978 | 978 | 1420 | 1730 |

Design Mechanical Data, Dimension , Materials and weight are subject to change without notice

Main Office : Jeddah - Industrial Zone Phase - 4, P. O. Box : 34572 , Jeddah: 21478 - Saudi Arabia ,
Tel +966-2-6370999 / 6081100 Fax +966-2-6365925 / 6379439 E-Mail : spsvalve@sps.net.sa , Web site :www.saudivalve.com